

TOTAL EXTENT (AS PER PATTA) : 2100 Sq.M
ROAD AREA : 556 Sq.M
NO. OF PLOTS : 8 Nos

NOTE:



1. SPLAY - 1.5M x 1.5M
2. MEASUREMENTS ARE INDICATED EXCLUDING SPLAY DIMENSIONS
3. ROAD AREA WAS HANDED OVER TO THE LOCAL BODY VIDE GIFT DEED DOC. No:2163/2020, DATED:19.02.2020 @ SRO AVADI

CONDITION:

TNCDBR -2019, RULE NO: 47 (11)

THE COST OF LAYING IMPROVEMENTS TO THE SYSTEMS IN RESPECT OF ROAD, WATER SUPPLY, SEWERAGE, DRAINAGE OR ELECTRIC POWER SUPPLY THAT MAY BE REQUIRED AS ASSESSED BY THE CONCERNED AUTHORITY, NAMELY, THE LOCAL BODY AND TAMIL NADU ELECTRICITY BOARD, SHALL BE BORNE BY THE APPLICANT.

LEGEND

-  SITE BOUNDARY
-  ROADS GIFTED TO THE LOCAL BODY
-  EXISTING ROAD

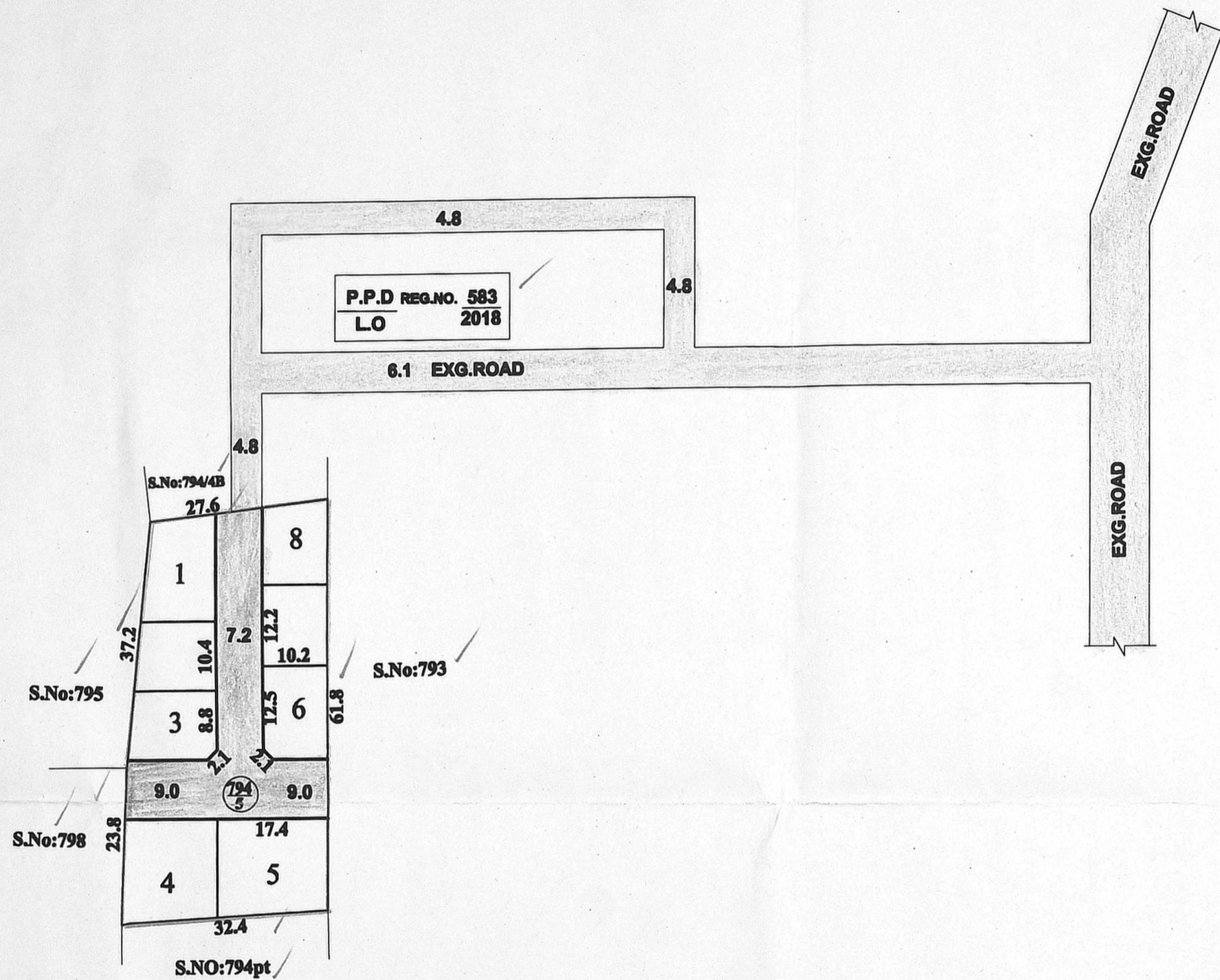

CONDITIONS:

THE LAYOUT APPROVED IS VALID SUBJECT TO OBTAINING SANCTION FROM THE LOCAL BODY CONCERNED.

P.P.D NO : 19
L.O NO : 2020

APPROVED

VIDE LETTER NO : L1/16681/2019
DATE : 27/02/2020

FOR CHIEF PLANNER (LAYOUT)
 CHENNAI METROPOLITAN
 DEVELOPMENT AUTHORITY



[Signature]
 27.2.2020
 PREPARED BY P.A.IV

[Signature]
 27/02/2020
 P.A-II

[Signature]
 27/02/2020
 A.P.

POONAMALLEE PANCHAYAT UNION

SUB-DIVISION OF HOUSE SITES IN S.No: 794/5 OF KUTHAMBAKKAM VILLAGE.

SCALE : 1:800 (ALL MEASUREMENTS ARE IN METRE.)